



# 2010 Annual Meeting

---

Sheraton, Downtown Los Angeles

September 7-9



# 2010 Annual Meeting Schedule

---

## Tuesday - September 7

TIME	SESSION TITLE	ROOM/LOCATION
9:00-4:00	Meeting on the links - CDSA Golf Outing	Wilson Municipal Golf Course
2:00-6:30	Open Registration	California Ballroom Foyer
4:00-6:00	CDSA Board Meeting	Terrace Boardroom
6:30-7:30	PR Committee Meeting	Terrace Boardroom
6:30-8:00	No Host Reception	The Lobby Bar
7:30	First Time Attendee Dinner	Meet in the Lobby

## Wednesday - September 8

TIME	SESSION TITLE	ROOM/LOCATION
7:30-8:00	Breakfast Buffet	California Ballroom Foyer
7:30-5:00	Open Registration	California Ballroom Foyer
8:00-9:15	<b>Opening Session</b> <ul style="list-style-type: none"><li>◦ Welcome</li><li>◦ Project SEARCH, Erin Riehle</li></ul>	California B Ballroom
9:30-10:45	<b>Training Session 1</b> <ul style="list-style-type: none"><li>◦ Project SEARCH: California Implementation and Q&amp;A</li><li>◦ Challenges in Relationships for Persons Impacted with Autism/Asperger's Disorder</li><li>◦ Microenterprises: Structure and Success</li></ul>	California A Ballroom Manhattan A Ballroom Venice Room
11:00-12:15	<b>Training Session 2</b> <ul style="list-style-type: none"><li>◦ Dealing with Union Formation</li><li>◦ Self-Advocacy and Legislative Input</li><li>◦ Emergency Preparedness</li></ul>	California A Ballroom Manhattan A Ballroom Venice Room
12:30-1:45	<b>Lunch with Speaker</b> <ul style="list-style-type: none"><li>◦ Impact of Health Care Reform, Kirby Bosley</li></ul>	California B Ballroom
2:00-3:15	<b>Training Session 3</b> <ul style="list-style-type: none"><li>◦ Aging in Individuals with DD</li><li>◦ Developing a Public Image</li><li>◦ TYZE: A Private Facebook-type Network</li></ul>	California A Ballroom Manhattan A Ballroom Venice Room

## Wednesday - September 8, Cont.

TIME	SESSION TITLE	ROOM/LOCATION
3:30-4:45	<b>Training Session 4</b>	
	<ul style="list-style-type: none"> <li>• Converting to the Community</li> <li>• Finding and Keeping Good Employees – A Research-based Approach</li> <li>• Ten Things Your Agency Should Be Doing</li> </ul>	California A Ballroom Manhattan A Ballroom Venice Room
6:00-9:00	<b>Hosted CDSA Reception for LA Legislators</b>	Polaris Room - 26 floor

## Thursday - September 9

TIME	SESSION TITLE	ROOM/LOCATION
7:30-8:00	<b>Breakfast Buffet</b>	California Ballroom Foyer
8:00-9:00	<b>Membership Meeting</b>	California B
9:15-Noon	<b>Public Policy</b>	Manhattan B/C
12:15 – 1:30	<b>Lunch with Panel Presentation</b>	California B
	<ul style="list-style-type: none"> <li>• Business Opportunities in Health Care Reform</li> </ul>	



## Los Angeles Sheraton

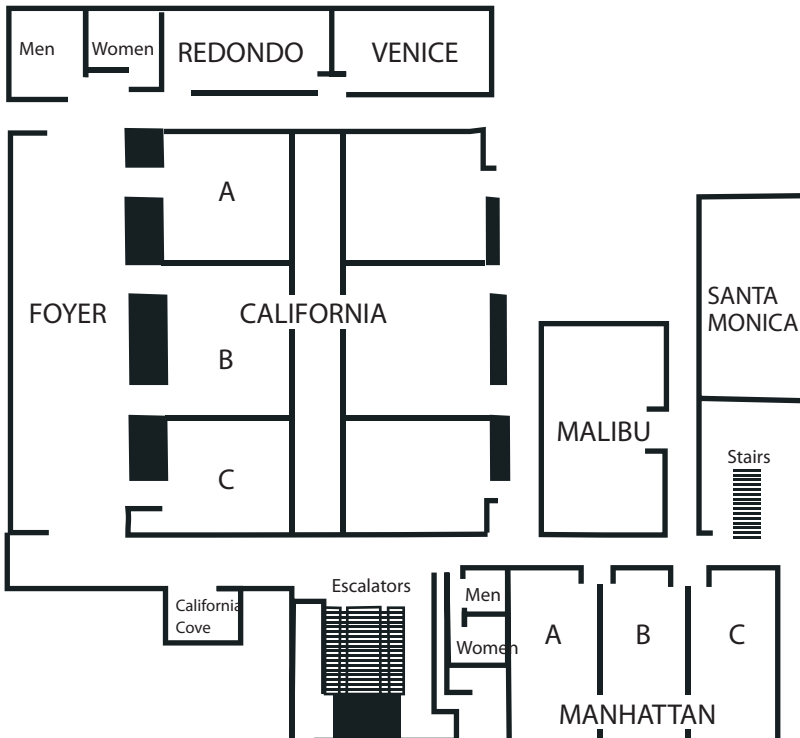

### Calling All Card Sharks to the Tuesday No Host Reception!

Join CDSA staff at the Lobby Bar from 6:30 - 8:00pm.

Enter a chance to win a drink on the house...CDSA!

Stop by the Lobby Bar to receive a playing card. Just like the old game of rummy, find two other members with cards that create a three-of-a-kind or a run and you each win a free drink!



Wednesday, September 8

General Session: 8:15am - 9:15am

### Project SEARCH

#### California B Ballroom

J. Erin Riehle, MSN, RN  
Director, Project SEARCH, Division of Disability Services  
Cincinnati Children's Hospital  
513-636-8729  
erin.riehle@cchmc.org

Project SEARCH provides employment and education opportunities for individuals with significant disabilities. The program educates employers about the potential of this underutilized workforce while meeting their human resource needs.

Erin Riehle, MSN, RN, is a recognized authority and national leader in promoting employment opportunities for people with disabilities and other barriers to employment. She is a founder and Senior Director of Project SEARCH, an employment and transition program that has received national recognition for innovative practices pioneered under Ms. Riehle's guidance.

In 2004, the US Department of Labor presented Project SEARCH the New Freedom Initiative Award, which is given annually to businesses and people that have demonstrated exemplary and innovative efforts in furthering the employment and workplace environment for people with disabilities. Ms. Riehle and Project SEARCH also have been recognized by the Ohio Governor's Council on People with Disabilities, the Ohio School Board Association, Down Syndrome Association of Greater Cincinnati, National Transition Alliance for Youth and Disabilities, National Association of State Directors of Vocational Technical Education, Ohio Association of Supervisors and Work-Study Coordinators, Inclusion Network, Association for Persons in Supported Employment, and Southwest Ohio Rehabilitation Association.



Wednesday, September 8

Training Session 1: 9:30am - 10:45am

### Project SEARCH: California Implementation and Q&A

#### California A Ballroom

Sara Murphy  
Director of WorkLink Program  
TransCen, Inc.  
785 Market Street, Suite 670  
San Francisco, CA 94103  
415-979-9520  
s\_murphy@sbcglobal.net

J. Erin Riehle, MSN, RN  
Director, Project SEARCH, Division of Disability Services  
PCincinnati Children's Hospital  
513-636-8729  
erin.riehle@cchmc.org

### An update on implementation of Project SEARCH in California followed by responses to audience questions.

For more than 20 years, Sara Murphy has established and managed transition and employment services for individuals with disabilities. She is the director of WorkLink (TransCen, Inc.'s San Francisco employment program), which has received national recognition for its high quality services and the innovative approach it uses to place job seekers with more significant support needs in career-oriented positions. She has worked on a number of local, state and federal initiatives concerning transition and employment services. In addition to managing the WorkLink program, Ms. Murphy is working with Project SEARCH to replicate their program model throughout California.

See above for Erin Riehle's bio.



Challenges in Relationships for Persons Impacted with Autism/Asperger's Disorder

Manhattan A Ballroom

Esther B. Hess, Ph.D.  
Developmental Psychologist & Executive Director  
Center for the Developing Mind  
2990 South Sepulveda Blvd., Suite #308  
Los Angeles, CA 90064  
310-652-7581  
Drhess@centerfortheDevelopingMind.com

Allen Samson  
Administrator for Developmentally Challenged Persons  
Ogden Manor Home  
904 North Ogden  
West Hollywood, CA 90046  
323-428-4643  
Ogdenmanorhome@aol.com

The complexities of relationship challenges that are inherent to Autism/Asperger's Disorder will be addressed. Included in this panel discussion will be a review of the necessary steps for the transition between educational setting/living in the parental home to achieving a work oriented program/ independent residential environment.

**Esther Hess** is a developmental psychologist and executive director of a multidisciplinary treatment facility in West Los Angeles, Center for the Developing Mind. The Center specializes in the assessment, diagnosis and treatment of persons impacted by developmental delays like Autism and Asperger's Disorder. Dr. Hess is certified in DIR/Floor Time and is one of Dr. Stanley Greenspan's Senior Clinicians on the West Coast. Dr. Hess speaks both nationally and internationally on DIR/Floor Time. She is currently writing a monthly column for *Los Angeles Family Magazine*, "Ask the Developmental Doc". Dr. Hess's many publications can be found on web site [www.centerfortheDevelopingMind.com](http://www.centerfortheDevelopingMind.com).

**Allen Samson** has a degree in administration for developmentally disabled persons. He has been the administrator at Ogden Manor Home for the last 30 years and specializes in transitional issues from home to more independent living for persons with developmental delays. He has sat on regional center steering committees and other organizations dealing with persons with special needs. Mr. Samson has a background in DIR/Floor Time and utilizes this developmental/relational approach with adults with Autism/Asperger's Disorder.



Wednesday, September 8

Training Session 1: 9:30am - 10:45am

---

### Microenterprises: Structure and Success Venice Room

Cassandra Tobey  
Micro-Enterprise Program Manager  
Goodwill of Orange County  
12371 Lewis St., Suite #103  
Garden Grove, CA 92840  
714-678-1460 ext. 123  
Cassandrat@ocgoodwill.org

Hear how Goodwill of Orange County has created successful microenterprises.

As Microenterprise Program Manager, [Cassandra Tobey](#) is directly responsible for the development and strategy implementation for the Goodwill Microenterprise Development Program. The two program tracks are: Customized Employment Options (for adults with developmental disabilities) and Future Business Owners (for low-income individuals who may have disabilities or other barriers to employment). In the three years since its inception, Cassandra has successfully managed the growth of the program starting from a small budget of \$70,000 to \$300,000 and from working solo to managing five staff. Cassandra has a Bachelor's degree in Business/Marketing and a Certificate in Career Development and Employment Supports.



Wednesday, September 8

Training Session 2: 11:00am - 12:15pm

---

### Dealing with Union Formation California A Ballroom

Carol Rogers  
Retired Executive Director,  
Kings Rehabilitation Center  
559-410-5070  
carogers1949@gmail.com

Learn the strategies Kings Rehabilitation Center used to connect with employees and forestall formation of a union.

[Carol Rogers](#) held the position of Executive Director for Kings Rehabilitation Center for seven years. Her focus during that time was to refine operations, improve program quality, obtain work contracts and increase the agency's visibility in the community. Prior to arriving at KRC, Carol worked for 31 years in the healthcare field. Education: BS degree in Organizational Management and a Master's in Healthcare Administration. Carol just recently retired from her position at KRC. She has plans to travel with her husband, exercise, join a book club and do the many things one cannot do when working full time!



Self-Advocacy and Legislative Input  
Manhattan A Ballroom

Kevin Christie  
CAC Board Member, ALIVE Consumer  
808 West Third Street  
Antioch, CA 94509  
925-779-1039

Cathy DeMello  
Executive Director  
Integrity House  
2043 N. Broadway  
Santa Ana, CA 92706  
714-390-7591  
cathydemello@gmail.com

Sam Durbin  
Public Relations/Advocate  
Integrity House  
2043 N. Broadway  
Santa Ana, CA 92706  
714-542-0855  
Samdurbin12@hotmail.com

Josh Sullivan  
Program Coordinator  
ALIVE East  
808 West Third Street  
Antioch, CA 94509  
925-779-1039  
joshsullivan@futures-explored.org

A self-advocacy program can have a significant impact on legislative issues and raise awareness of your agency.

As a person living with CP, [Kevin Christie](#) has led a pretty extraordinary life. Kevin strives to live a life of creativity and independence. Even though Kevin is non-verbal, he has found his voice through many creative outlets, including writing and directing films, ads, and music. Kevin is an active member of ALIVE and its Consumer Action Committee which is dedicated to giving a face and voice to a group (DD community) so often forgotten.

Twenty-three years ago, [Sam Durbin](#) was living on the streets. When the authorities found him, he was placed in a state institution and declared a "hopeless case." Sam has three disabilities: developmental, brain injury and a severe mental illness. Sam is a member and staffer at Integrity House and his job is public relations and advocacy. Sam wrote a book called, *You're Not the Boss of Me*, about self-determination. A student at Chapman University made a documentary about Sam. Sam has been a speaker at many conferences, and is the chairperson of the DDS consumer advisory committee.

*Shhh, don't tell Josh but the Consumer Action Committee is writing Josh's bio for him. . .*

As Program Coordinator for ALIVE, [Josh Sullivan](#) is a fun loving guy who is quite the character! He doesn't think he does much work around here; but we beg to differ. He is always ready and willing to help, whenever you call him, for whatever reason. When working as an aide, Josh treats us in a way that makes us understand that we can be someone in this world and take control of our own lives. As an advocate, he's like 'the Hulk'... JOSH SMAAAASH RAWWWRRRR!!!



Wednesday, September 8

Training Session 2: 11:00am - 12:15pm

### Emergency Preparedness

#### Venice Room

Mary Vreeland  
Vreeland Safety Consulting  
3601 Pine Avenue  
Los Angeles, CA 90049  
310-944-1914  
maryvreeland@yahoo.com

Being prepared can reduce anxiety and losses that accompany disasters. We should be ready to evacuate and to care for the basic medical needs of others.

Mary Vreeland is a certified ergonomist and safety professional, with 23 years of experience. She started Vreeland Safety Consulting in 2008.

Recently, Mary has been working in the Gulf Coast at the Incident Command Center in response to the BP Oil spill. The workers in the Gulf Coast are exposed to a variety of hazards, including extreme heat, lightning and chemical exposures. In addition, there have already been three shut downs due to possible hurricanes.

Today, Mary would like to share her experience and discuss ways that we can prepare for disasters to protect ourselves and those around us, especially the disabled.



Wednesday, September 8

Lunch & Speaker: 12:30pm - 1:45pm

### Impact of Health Care Reform

#### California B Ballroom

Kirby G. Bosley, CEBS  
Senior Vice President, West Region Leader, Health & Benefits  
Aon Consulting  
707 Wilshire Blvd., Suite 2600  
Los Angeles, CA 90017  
213-630-2903

An overview of the intent, key features, and timing of the major provisions of health care reform as well as a discussion of implications that CDSA members will want to consider in their business planning.

Kirby Bosley is a Senior Vice President for Aon Consulting World-wide, with more than 25 years of experience working with large, complex clients in the areas of health and benefits strategic planning, design, and management. Kirby is often cited in the press regarding health care issues, including the LA Times, Business Insurance, the New York Times, and other publications, as well as having appeared on CNN and MSNBC and radio on these topics.

Kirby is a graduate of Mount Holyoke College, with a B.A. in English. She also holds the Certified Employee Benefits Specialist (CEBS) designation.



Wednesday, September 8

Training Session 3: 2:00pm - 3:15pm

### Aging Issues in Individuals with Developmental Disabilities

California A Ballroom

Linda Nelson, PhD, ABPN  
Clinical Neuropsychologist; Professor, Emerita,  
Psychiatry & Biobehavioral Sciences  
UCLA, Semel Institute  
Room 37-3608  
760 Westwood Plaza  
Los Angeles, CA 90095  
310-206-8100 / 310-451-9100 / 310-458-4581  
LNelson@Mednet.ucla.edu

Individuals with Developmental Disabilities may age differently than the general population. This workshop will educate participants on specific and unique issues regarding normal and abnormal aging in people with Developmental Disabilities.

Dr. Linda Nelson is Professor, Emerita, Psychiatry and Biobehavioral Sciences at UCLA and adjunct Professor of Psychology at Pepperdine University. Her work is primarily in the field of neuropsychology. She also does individual adult psychotherapy on a limited basis. She is the Principal Investigator of studies concerning diagnosis and treatment of Alzheimer's disease at UCLA. Her research blends neuropsychology and nuclear medicine to achieve more reliable diagnoses of Alzheimer's disease and, by implication, earlier treatment to slow its progression. She maintains a private practice in Santa Monica that treats adult patients, children and their families.



Wednesday, September 8

Training Session 3: 2:00pm - 3:15pm

### TYZE: A Private Facebook-type Network

Venice Room

Kevin Christie  
CAC Board Member, ALIVE Consumer  
808 West Third Street  
Antioch, CA 94509  
925-779-1039

Josh Sullivan  
Program Coordinator  
ALIVE East  
808 West Third Street  
Antioch, CA 94509  
925-779-1039

joshullivan@futures-explored.org

TYZE is an innovative, intuitive, and versatile tool that allows groups to plan and interact in a closed web environment. Please bring a network-enabled laptop/netbook as we will be creating a live network for demonstration!

As a person living with CP, Kevin Christie has led a pretty extraordinary life. Kevin strives to live a life of creativity and independence. Even though Kevin is non-verbal, he has found his voice through many creative outlets, including writing and directing films, ads, and music. Kevin is an active member of ALIVE and its Consumer Action Committee which is dedicated to giving a face and voice to a group (DD community) so often forgotten.

*Shhh, don't tell Josh but the Consumer Action Committee is writing Josh's bio for him...*

As Program Coordinator for ALIVE, Josh Sullivan is a fun loving guy who is quite the character! He doesn't think he does much work around here; but we beg to differ. He is always ready and willing to help, whenever you call him, for whatever reason. When working as an aide, Josh treats us in a way that makes us understand that we can be someone in this world and take control of our own lives. As an advocate, he's like 'the Hulk'... JOSH SMAAAASH RAWWWRRRR!!!



Developing a Public Image: Branding, Guerilla Marketing, and Facebook Friendraising

Manhattan A Ballroom

Nancy Batterman  
Chief Executive Officer  
Employment & Community Options  
8555 Aero Drive, Suite 102  
San Diego, CA 92123  
858-565-9870 ext.104  
nbatman@communityoptions.org

Cindy Burton  
President/CEO  
PathPoint  
315 W. Haley Street, Suite 102  
Santa Barbara, CA 93101  
805-966-3310 ext. 12  
Cindy.Burton@pathpoint.org

Jacquie Dillard-Foss  
Executive Director  
jacquied@stepagency.com

Lynn Frampton  
Medical Liaison  
lynnf@stepagency.com

Strategies to Empower People, Inc. (STEP)  
5945 Palm Drive  
Carmichael, CA 95608  
916-679-1555

You can build the image of your agency without spending big bucks – just use your head. Learn about specific techniques that you can apply to build the public image of your agency – and of CDSA.

Nancy Batterman has been with E&CO for its entire 25-year history and she's been CEO since 1992. She has her MA in education with an emphasis in special education and an MBA, both from San Diego State University. Batterman is recognized throughout the state for her leadership in the area of vocational rehabilitation and the employment of people with developmental disabilities.

Cindy Burton has been with PathPoint (formerly Work Training Programs, Inc.) since 1987, having originally joined the organization as corporate controller. With a Liberal Arts background (BA UCSB) and training as a Certified Public Accountant (passed the CPA exam in 1991), Cindy was responsible for PathPoint's internal operations at each program site, prior to her appointment in 1994 to the position of Executive Director. During her tenure as CEO, PathPoint has grown from a \$6 million organization to more than \$24 million in annual revenue. Current affiliations:

- Santa Barbara County Workforce Investment Board 2004-Present (Treasurer 2010-11)
- CDSA PR Committee Chair 2010-11

The STEP program began in 1992 and currently provides supported living, independent living, and vocational support programs in the Greater Sacramento, Yuba and surrounding counties. The emphasis of STEP is providing inclusive community options for all clients. This unique agency specializes in providing personalized services and supports to deaf and deaf/blind developmentally disabled adults. STEP currently supports more than 350 individuals and employs over 500, with 150 of those employed being deaf themselves.



Converting to the Community  
California A Ballroom

Diana DeRodeff  
Executive Director  
InAlliance  
6950 21st Avenue  
Sacramento, CA 95820  
916-381-1300 ext. 102  
DDeRodeff@inallianceinc.com

Fred Robinson  
CEO  
The Arc of Ventura County  
5103 Walker Street  
Ventura, CA 93003  
(805) 650-8611 ext. 26  
frobinson@arcvc.org

Rex Zimmerman  
Director, Employment Services  
HOPE Services  
30 Las Colinas Lane  
San Jose, CA 95119  
831-345-5271  
RZimmerman@Hopeservices.org

Three who have navigated the conversion to community-based work programs share how and how not to proceed.

**Diana DeRodeff**, led InAlliance through the transition from sheltered workshop to supported employment some 20 years ago. Her perpetual involvement with CDSA has landed her in virtually every leadership chair. Currently, she represents CDSA on the DDS Budget Advisory Group and serves on Public Policy and Public Relations committees. The fact she is on two panels during the Annual Meeting reflects her inability to say “No” when CDSA needs her help. Diana claims she wants to retire so that she can ride her bike 100 miles every day.

**Fred Robinson** has more than 40 years of experience serving people with developmental disabilities. In 1990, he was appointed CEO of The Arc of Ventura County. Under his leadership, The Arc has grown from an annual budget of \$3 million to \$14 million, and currently serves nearly 700 individuals. Mr. Robinson is committed to full, inclusive lives for people with developmental disabilities. He is active in Kiwanis and has served as President of his Club, and Lt. Governor for Division 42 (Ventura & Santa Barbara Counties). In November 2008, Mr. Robinson was elected to the Santa Paula City Council.

**Rex Zimmerman**, is Director of Employment Strategies for HOPE Services. In 2007 HOPE started its transition of nine workshops to community-based services. HOPE views this transition as a value-driven as well as a business-based process. He wrote about this last year in an article in the Journal of Vocational Rehabilitation, in which he suggests social capital can play a role in overcoming the challenges of transition. Mr. Zimmerman is a member of the Bay Area Caucus.



Wednesday, September 8

Training Session 4: 3:30am - 4:45am

---

Finding and Keeping Good Employees –  
A Research-based Approach

Manhattan A Ballroom

Ronald Wolff  
President/CEO  
OPARC  
9029 Vernon Avenue  
Montclair, CA 91763  
909-985-3116 ext. 25

A pre-employment screening test designed and used at OPARC will be explained and discussed, along with research-based non-monetary motivational techniques.

Ronald Wolff, Psy.D., has been President/CEO of OPARC since 1995. During his tenure the number of clients served by the agency has tripled, and the annual budget has quadrupled. Ron brings to this presentation an extensive knowledge of both clinical and experimental psychology, combined with recent research on “happiness” for a book project.



Wednesday, September 8

Training Session 4: 3:30am - 4:45am

---

Ten Things Your Agency Should  
Be Doing

Venice Room

Chad Carlock  
Esquire  
Law Offices of Chad Carlock  
260 Russell Boulevard, Suite D  
Davis, CA 95616  
530-750-3000  
ccarlock@jps.net

A brief review of ten administrative practices you should implement and the potential consequences of not doing so.

Chad Carlock advises and represents vendors, parents, families and advocates in the area of developmental disabilities throughout California. He opened his practice in downtown Davis in 2000. From 1996 to 2000, Mr. Carlock was an associate with the Law Offices of David Rosenberg. His practice includes administrative and government law, civil litigation, business law and contracts, local and state government, landlord/tenant law, and trial and appellate work. Mr. Carlock is licensed to practice before all California courts, the US District Court (Eastern District of California), the Federal Ninth Circuit Court of Appeals, and the US Supreme Court.



Business Opportunities in Health  
Care Reform

California B Ballroom

Terry Colborn  
Vice President of Programs & Government Affairs  
Easter Seals Superior  
3205 Hurley Way  
Sacramento, CA 95864  
(916) 485-6711  
terryc@essuperior.org

Diana DeRodeff  
Executive Director  
InAlliance  
6950 21st Avenue  
Sacramento, CA 95820  
916-381-1300 ext. 102  
DDeRodeff@inallianceinc.com

Jacque Dillard-Foss  
Executive Director  
Strategies to Empower People, Inc. (STEP)  
5945 Palm Drive  
Carmichael, CA 95608  
916-679-1555  
jacquied@stepagency.com

Sue North  
Lobbyist  
Rose & Kindel  
915 "L" Street, Suite 1210  
Sacramento, California 95814  
(916) 441-1034  
snorth@rosekindel.com

An exploration of new business opportunities for  
service providers emerging from expansion of Medicaid  
and private health insurance coverage/benefits in the  
health care reform act.

As VP of Programs and Government Affairs at Sacramento's Easter Seals Superior California, [Terry Colborn](#) is one of the "usual suspects" in a wide variety of legislative coalitions and outreach activities to policy makers. He speaks passionately about the range of programs Easter Seals offers and their impact on children and adults with disabilities. He serves on the CDSA Public Policy Committee and perennially participates in parsing pending legislation. In his spare time, he leads birding tours for the Audubon Society and serves on the Board of the Yolo Basin Foundation. This explains why he always sits at the back of the room and uses binoculars.

[Diana DeRodeff](#) says she is an innocent bystander on this panel. Her perpetual involvement with CDSA has landed her in virtually every leadership chair. Currently, she represents CDSA on the DDS Budget Advisory Group and serves on Public Policy and Public Relations committees. The fact she is on two panels during the Annual Meeting reflects her inability to say "No" when CDSA needs her help.

[Jacque Dillard-Foss](#) is executive director of the STEP program, which began in 1992 and currently provides supported living, independent living, and vocational support programs in the Greater Sacramento, Yuba and surrounding counties.. The emphasis of STEP is providing inclusive community options for all clients. This unique agency specializes in providing personalized services and supports to deaf and deaf/blind developmentally disabled adults. STEP currently supports more than 350 individuals and employs over 500, with 150 of those employed being deaf themselves.

[Sue North](#) joined Rose & Kindel in January of 2009 after staffing the Legislature and related work for 30 years. Her duties have included Chief Consultant to the Senate Human Services Committee, Executive Director of the Joint Legislative Blue Ribbon Commission on Autism, government affairs consultant to the California Institute for Regenerative Medicine, and Chief of Staff to Senators Elaine Alquist and John Vasconcellos. For the State Assembly, she managed the budgets under the Health and Welfare Agency with the Ways and means Committee and staffed the Joint Legislative Audit Committee and the Select Committee on Mental Health.

### Audit Committee

Chair: Karen Jones karen@pvwonline.org  
Wendy Rogina wendyr@vipsolutions.com  
Kirk Spry kspry@vtc-sm.org

### CARI Committee

Chair: Ron Killingsworth ron.cdasa@yahoo.com  
Anthony DeSalis adesalis@arc-sd.com  
John Nash jnash@pswrehab.com  
Joan McKinney jmckinney@caelwyn.org  
Dave Kyle dkyle@barc-inc.org  
Joe Mitchell ceo@industrial-support.org  
Staff: Andrea Gallippi agallippi@cal-dsa.org

### Caucus Steering Committee

Chair: Tim Chervenak (Orange) tim@proindependence.org  
Wende Leigh-Ayers (Central Valley) wende@ableindustries.org  
Carl Ochsner (Upstate) carlo@ewtc.org  
Robin Rhoades (Capitol) robin@southsideartcenter.com  
Kirk Spry (Central Coast) kspry@vtc-sm.org  
Mike Huckins (Bay Area) mike@bayrespitecare.org  
Andrea Wells (Inland Empire) andreaatexceed@aol.com  
Bill Mara (San Diego) billm@teriinc.org  
Staff: Jim Scott jscott@cal-dsa.org

### Membership Committee

Chair: Sylvia Anderson programs@industrialsupport.org  
Mike Foster shellaceo@msn.com  
Mike Huckins mike@bayrespitecare.org  
Beth Kahiga beth@napavalleysupportservices.org  
Carl Ochsner carlo@ewtc.org  
Fred Robinson frobinson@arcvc.org  
Liz Sutton liz@nbrs.org  
Diane Toevs respiteincpc@sbcglobal.net  
Staff: Jim Scott jscott@cal-dsa.org

### Public Policy Committee

Chair: Barbara Maizie bmaizie@arcofcc.org  
Donna Bettencourt dbettencourt@inallianceinc.com  
Peter Bowers pbowers1@ix.netcom.com  
Tim Chervenak tim@proindependence.org  
Terry Colborn terryc@essuperior.org  
Diana DeRodeff dderodeff@inallianceinc.com  
Jacquie Dillard-Foss jacquied@stepagency.com  
Mike Foster shellaceo@msn.com

### Public Policy Committee, Cont.

Joyce Hearn jhearn2001@yahoo.com  
Kathryn Hebel khebel@vocationalvisions.org  
Randy Hyatt sgvtc1@aol.com  
Del Lockwood dlockwood@co.shasta.ca.us  
John Nash jnash@pswrehab.com  
Dianne Rose tcrcsrespice@sbcglobal.net  
Will Sanford willsanford@futures-explored.org  
Sam Seaton sseaton@prideindustries.com  
Alice Tapley yoloworks@aol.com  
David Tolliver ccc\_dtolliver@sbcglobal.net  
Aaron Kitzman akitzman@villasperanzaservices.org  
Maureen Wright therespiteinn@att.net  
Rex Zimmerman rzimmerman@hopeservices.org  
Dwight Hansen dhansen@hansenassociates.org  
Carl London clondon@rosekindel.com  
Sue North snorth@rosekindel.com  
Staff: Chris Rice crice@cal-dsa.org

### Public Relations Committee

Chair: Cindy Burton cindy.burton@pathpoint.org  
Diana DeRodeff dderodeff@inallianceinc.com  
Sandy Doughty doughtyto@charter.net  
Kathryn Hebel khebel@vocationalvisions.org  
Ron Killingsworth ron.cdasa@yahoo.com  
Diane Toevs respiteincpc@sbcglobal.net  
Shirley Yamano shirley@vipsolutions.com  
Staff: Chris Rice crice@cal-dsa.org

### Structure and Resources Committee

Chair: Barbara Maizie bmaizie@arcofcc.org  
Liz Sutton liz@nbrs.org  
Sylvia Anderson programs@industrial-support.org  
Cindy Burton cindy.burton@pathpoint.org  
Tim Chervenak tim@proindependence.org  
Terry Colborn terryc@essuperior.org  
Joyce Hearn jhearn2001@yahoo.com  
Karen Jones karen@pvwonline.org  
Ron Killingsworth ron.cdasa@yahoo.com  
Del Lockwood dlockwood@co.shasta.ca.us  
David Tolliver ccc\_dtolliver@sbcglobal.net  
Kelly Whitev kwhite@villasperanzaservices.org  
Kirby Wohlander kirbyw@tmi-inc.org  
Staff: Chris Rice crice@cal-dsa.org



## Board of Directors

### CALIFORNIA DISABILITY SERVICES ASSOCIATION

President	Patty Enger	patty.enger@pathpoint.org
President-Elect/Treasurer	Ron Killingsworth	ron.cdasa@yahoo.com
Vice President	Sylvia Anderson	programs@industrial-support.org
Imm Past-President	Carl Ochsner	carlo@ewtc.org
Directors	Joyce Hearn (2009-11)	jhearn2001@yahoo.com
	Wendy Rogina (2010-12)	wendyr@vipsolutions.com
	Sam Seaton (2009-11)	sseaton@prideindustries.com
	Liz Sutton (2009-11)	liz@nbrs.org
	Kirby Wohlander (2010-12)	kirbyw@tmi-inc.org
Executive Director	Chris Rice	crice@cal-dsa.org

### CALIFORNIA DISABILITY SERVICES INSTITUTE

President	Nancy Batterman	nbatman@communityoptions.org
Secretary	Vic Wursten	vwursten@prideindustries.com
Treasurer	Carl Ochsner	carlo@ewtc.org
Directors	Pam Jensen	pamjensen@uvah.org
	George Molano	gmolano@hopeservices.org
	Fred Robinson	frobinson@arcvc.org
	Will Sanford	willsanford@futures-explored.org
	Cheryl Whiting-Wright	cwrightdcp@hotmail.com
	Kirby Wohlander	kirbyw@tmi-inc.org
Staff	Chris Rice	crice@cal-dsa.org

### DYNAMIC SOLUTIONS

Chair	Chris Rice	crice@cal-dsa.org
Vice-Chair	David De Leonardis	davidd@crossroadsdiversified.com
Treasurer	Patty Enger	patty.enger@pathpoint.org
Secretary	Will Sanford	willsanford@futures-explored.org
Director	Lane Ronnow	sir@jps.net



## Upcoming Meetings

Northern Policy Meeting  
 CDSA Office, Sacramento  
 January 27, 2011

Leadership Retreat (North)  
 CDSA Office, Sacramento  
 April 26-27, 2011

Southern Policy Meeting  
 San Gabriel Valley Training Center  
 January 26, 2011

Board Retreat (South)  
 Project Independence  
 May 24-25, 2011

2011 Legislative Conference  
 Citizen Hotel, Sacramento  
 March 15-16, 2011

## Annual Meeting Sponsor

---



**DYNAMIC SOLUTIONS**  
INSURANCE SERVICES  
Lic.#0G13622

## Annual Meeting Exhibitors

---



Matthew Rogina  
239 West Court Street, Building A  
Woodland, CA 95695  
(530) 668-2777  
mrogina@armstrongprofessional.com  
www.armstrongprofessional.com



www.EssentialLearning.com  
800.729.9198

Bobbie Theodore  
Director, Business Development  
10755-F Scripps Poway Pkway #587  
San Diego, CA 92131  
(800) 729-9198 ext. 284  
info@essentiallearning.com  
www.essentiallearning.com



Melani Conti  
Senior Vice President  
1350 Carlback Ave #200  
Walnut Creek, CA 94549  
(925) 295-2542  
melanic@heffins.com  
www.heffgroup.com



Kent P. Woodward  
Group Insurance Consultant  
P.O. Box 254700  
Sacramento, CA 95865  
(800) 423-0303  
kpwoodward@scif.com  
www.statefundca.com

## LA Legislator Reception Sponsors

---



**DYNAMIC SOLUTIONS**  
INSURANCE SERVICES  
Lic.#0G13622

**San Gabriel Valley**  
Training Center

Community Rehabilitation  
Training Center





# LA Legislator Reception

Sheraton, Downtown Los Angeles

September 8, 2010

6:00 - 9:00pm



Wednesday, September 8

LA Legislator Reception: 6:00 - 9:00pm

---

We invite all Annual Meeting attendees to help us welcome LA Legislators! This year's Annual Meeting includes a special reception for Los Angeles County Legislators on Wednesday, September 8, from 6:00 to 9:00 pm in the Polaris room (26th floor).

We want everyone to attend to build the crowd and enthusiasm. LA member agencies will each have a tabletop display space at the reception. And we hope you'll visit the agency displays to learn about fellow members.

Ushers will be stationed in the lobby area directing Legislators to the Polaris room. Upon arrival, each Legislator will be paired with a tour guide who will have a list of member agencies in the Legislator's district. Tour guides will then take the Legislator from member display to member display.

This is where you can get involved! All attendees are asked to check-in at the registration desk near the California Ballroom at 5:00pm on Wednesday to receive their mission for the reception (if you so choose to accept).



Thank You to Our Sponsors!

---



**San Gabriel Valley**  
Training Center  

---

Community Rehabilitation  
Training Center





## Invited LA County Legislators and Candidates

Assembly Member Knight	District 36	Senator Runner	District 17
Assembly Member Strickland	District 37	Senator Strickland	District 19
Assembly Member Smyth	District 38	Senator Padilla	District 20
Assembly Member Fuentes	District 39	Senator Liu	District 21
Assembly Member Blumenfield	District 40	Senator Cedillo	District 22
Assembly Member Brownley	District 41	Senator Pavley	District 23
Assembly Member Feuer	District 42	Senator Romero	District 24
Assembly Member Krekorian	District 43	Senator Wright	District 25
Assembly Member Portantino	District 44	Senator Price, Jr.	District 26
Assembly Member De Leon	District 45	Senator Lowenthal	District 27
Assembly Member Perez	District 46	Senator Oropeza	District 28
Assembly Member Bass	District 47	Senator Huff	District 29
Assembly Member Davis	District 48	Senator Calderon	District 30
Assembly Member Eng	District 49	Senator Negrete McLeod	District 32
Assembly Member De La Torre	District 50	Candidate Jeff Gorell	District 37
Assembly Member Bradford	District 51	Candidate Mike Gatto	District 43
Assembly Member Hall III	District 52	Candidate Gil Cedillo	District 45
Assembly Member Lieu	District 53	Candidate Holly Mitchell	District 47
Assembly Member Lowenthal	District 54	Candidate Betsy Butler	District 53
Assembly Member Furutani	District 55	Candidate Roger Hernandez	District 57
Assembly Member Mendoza	District 56	Candidate Tim Donnelly	District 59
Assembly Member Hernandez	District 57	Candidate Kevin de Leon	District 22
Assembly Member Calderon	District 58	Candidate Dr. Ed Hernandez	District 24
Assembly Member Adams	District 59		
Assembly Member Hagman	District 60		
Assembly Member Torres	District 61		



### LA County Member Agencies

- |                                                  |                                        |
|--------------------------------------------------|----------------------------------------|
| 1. Association for Retarded Citizens, Long Beach | 12. Jessar Inc.                        |
| 2. Build Rehabilitation Industries, Inc.         | 13. Lincoln Training Center            |
| 3. Channel Islands Social Services               | 14. PathPoint                          |
| 4. Community Rehabilitation Training Center      | 15. Penn Rehabilitation Center         |
| 5. Desert Haven                                  | 16. Pleasantview Industries, Inc.      |
| 6. Elwyn California                              | 17. Pomona Valley Workshop             |
| 7. Exceptional Children's Foundation             | 18. PRIDE Industries                   |
| 8. Foothill Vocational Opportunities, Inc.       | 19. San Gabriel Valley Training Center |
| 9. Glendale Association for the Retarded         | 20. Villa Esperanza Services           |
| 10. California MENTOR                            | 21. Wellspring Home Services           |
| 11. Innovative Rehabilitation Services           |                                        |

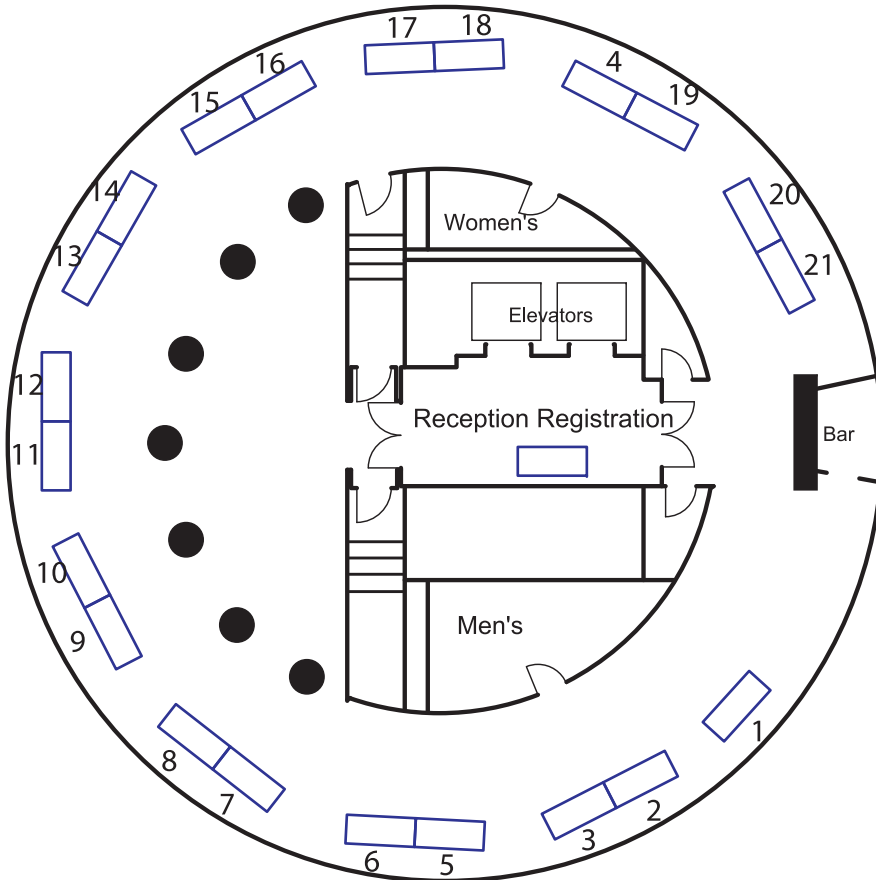

**POLARIS - 26th Floor**